

DIRECTIONS FOR USE

Dear Customer,

Thank you for purchasing Polysack's quality thermal screen for energy saving in greenhouses. Please work according to the following instructions to ensure correct and successful screen installation.

ALUMINET IC is a woven fabric, manufactured from metallized and clear polyethylene flat yarns. The yarns are UV stabilized and the fabric is flexible, light and strong.

After use ALUMINET IC can be recycled as a polyethylene waste.



TRANSPORTATION AND STORAGE

ALUMINET IC should be stored and transported under the following conditions:

- Temperatures not exceeding 65 °C
- Relative humidity up to 50%
- In a ventilated area
- Away from heating devices (prevent contact with hot appliances)
- Away from chemicals, especially corrosive substances: acids, sulfur bases



INSTALLATION

Care should be taken to:

- Avoid mechanical damage and ruptures
- Avoid snagging on sharp objects eg. Wire and cable ends, bolts etc. Where necessary these object should be wrapped to prevent damage to the screen.
- Prevent direct contact with metal parts of the construction. Where necessary, cover metal parts with white paint or insulating material
- Avoid applying non - uniform tension while spreading the screen as this could cause distortion of the screen.

- Prevent contact with hot tools which may cause damage by melting the plastic yarns of the screen
- Ensure temperatures not greater than 65°C even when the structure is not in use
- Where necessary, operate ventilation and cooling systems to keep temperatures moderate
- Perform alterations such as sewing edges, shortening screen length etc., according to the installers guide provided by Polysack.



USE AND MAINTAINANCE

- Avoid continuous water spraying directly on the net
- Avoid direct contact with chemicals, chlorine based products, halogens, solvents, cleaning agents, highly acidic substances or sulfur base materials
- Do not aim the mist or fogger's stream directly on to the net
- Hot gas from exhaust pipe emmitances can damage the product
Keep working vehicles at a distance of at least 5 meters from the net screen
- Keep net away from open flame.

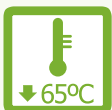



INSTALLERS GUIDE

METHOD 1

Where cutting of the fabric is necessary, please work according to the following instructions to ensure correct and successful screen installation.

1. Affix POLYSACK metallized adhesive tape to the fabric along the intended cutting line.
2. Use a smooth solid object to apply pressure by rubbing along the length of the tape to ensure proper adhesion of the tape to the fabric.
3. With the aid of scissors, a sharp blade or heat knife, cut along the centre of the tape.

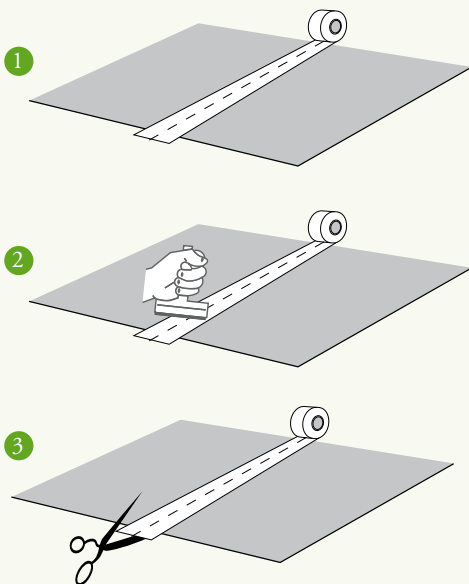

METHOD 2

1. Affix masking tape (Cello tape) to the fabric along the intended cutting line.
2. With the aid of scissors, a sharp blade or heat knife cut the fabric along the centre of the tape.
3. Double fold the cut edge and sew the resulting hem with a portable sewing machine (using only sewing yarn approved by Polysack). Alternatively it is possible with the aid of a stapler, to staple the hem using rust roof staples.

